

# CERTIFICATE OF LOCATION OF GOVERNMENT CORNER

NORTH QUARTER Corner of Section 36, Township 107, Range 42, 5TH P.M.

STATE OF MINNESOTA, County of MURRAY

At the corner location shown on the sketch:

On 09-05-2012 found a large field stone with "X" chiseled in the top center and  
DATE a 5/8" iron on the south side of the stone.

left monument as found,  lowered monument,  removed monument (explain)

On \_\_\_\_\_ placed a \_\_\_\_\_  
DATE

### SKETCH OF REFERENCE TIES

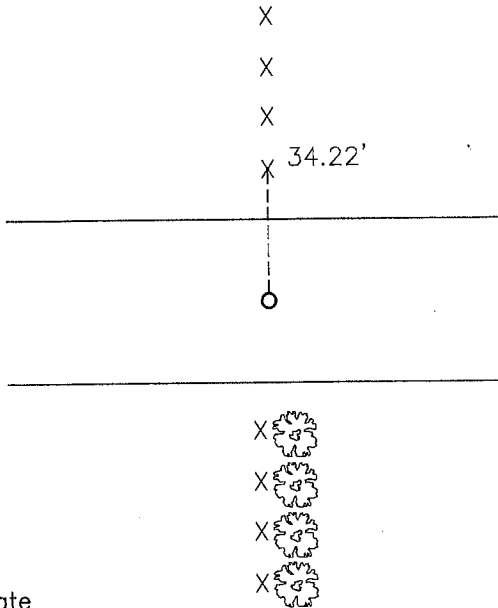

Minnesota State Plane Coordinate  
System Murray County Datum  
NAD83 (1996)

N: 168821.458  
E: 482401.537

Nail and seal in corner fence post North 34.22'

Statement of evidence relative to this corner location is on back of page.

I hereby certify that this document and the data contained herein was prepared by me or under my direct supervision.

*James H. Buehler* 2/22/13  
SIGNATURE DATE

Registration No. 43844

Land Surveyor,  Professional Engineer  
 County Surveyor,  County Engineer

### OFFICE OF THE COUNTY RECORDER

County of \_\_\_\_\_

I hereby certify that this document was filed in the Co. Recorders office at \_\_\_\_\_ .M on the \_\_\_\_\_ day of MAY 23 2013 A.D. 20 \_\_\_\_\_

County Recorder *James V. Johnson*  
By \_\_\_\_\_, Deputy

DOCUMENT NO. \_\_\_\_\_

## Statement of Evidence

In 1861, L. G. M. Fletcher did the original subdivision of the township.

On October 24, 1988, Moseng Land Surveying found a field stone at the corner. They set an iron and railroad spike along side of the stone.

On September 5, 2012, Bueltel-Moseng Land Surveying found a large field stone with a "X" chiseled in the top center and a  $\frac{5}{8}$ " iron along the south side of it.